



HOTEL EDMONTON SOUTH

PARKING AT THE RADISSON EDMONTON SOUTH

The Radisson Edmonton South is pleased to offer complimentary surface and underground parking.

This letter is to provide the parking instructions for your function at our property so to avoid any inconveniences such as parking tickets, for your participants. **The hotel does share our parking with the adjacent office tower and there are some "No Parking" zones.**

SURFACE PARKING: Please see the attached map for available spaces for anyone attending functions within the hotel. The areas in **RED** are the only areas not available to hotel guests. Once parked in a surface parking stall, all guests **must register their license plate** with the Front Desk (only required for event from 8:00am – 5:00pm, Monday to Friday), to avoid being ticketed.

UNDERGROUND PARKING: The underground parking is accessed by a security code that changes weekly or key card for registered hotels guests. Once in the underground parking, only park in the spaces marked as **"Hotel Guest Parking"** in the **GREEN** areas marked on P1 or P2 Parking levels.

The **Security Code** for the week of your function is: **74371#**

***In the event you are not able to find parking in one of the designated parking areas (Surface, P1 or P2) please come and see a member of our Front Desk team for further assistance.

Please ensure this information is communicated to all participants attending your function at the Radisson Edmonton South. If you have any questions or need any clarification, please do not hesitate to contact your sales person or the Radisson Edmonton South switchboard at (780) 437-6010.

Please note that the Radisson Edmonton South will not be responsible for any parking tickets incurred if you are not parked in the designated areas.

Radisson Edmonton South, 4440 Gateway Blvd. Edmonton AB, T6H 5C2

Surface Parking

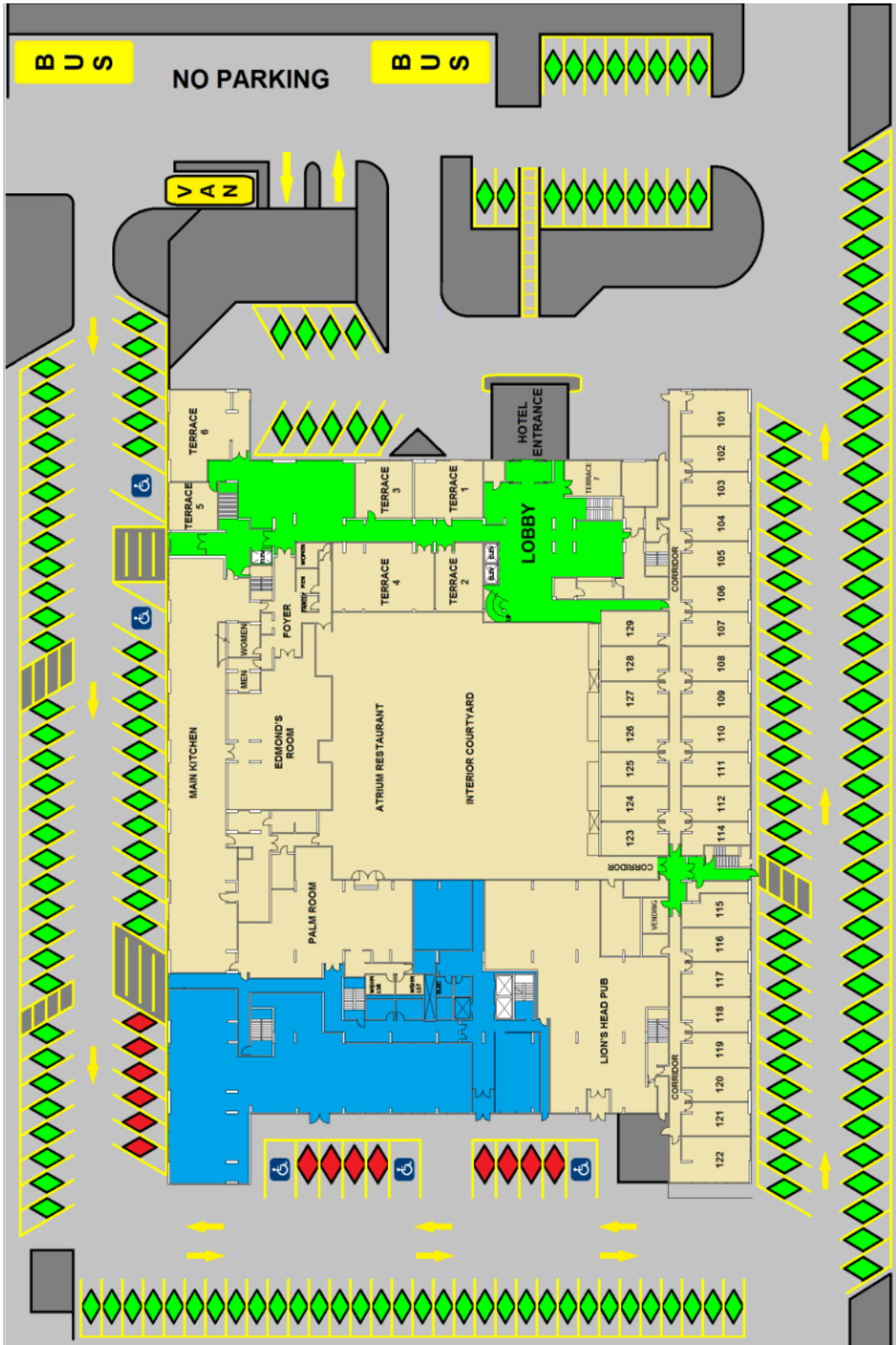

P1 Parking

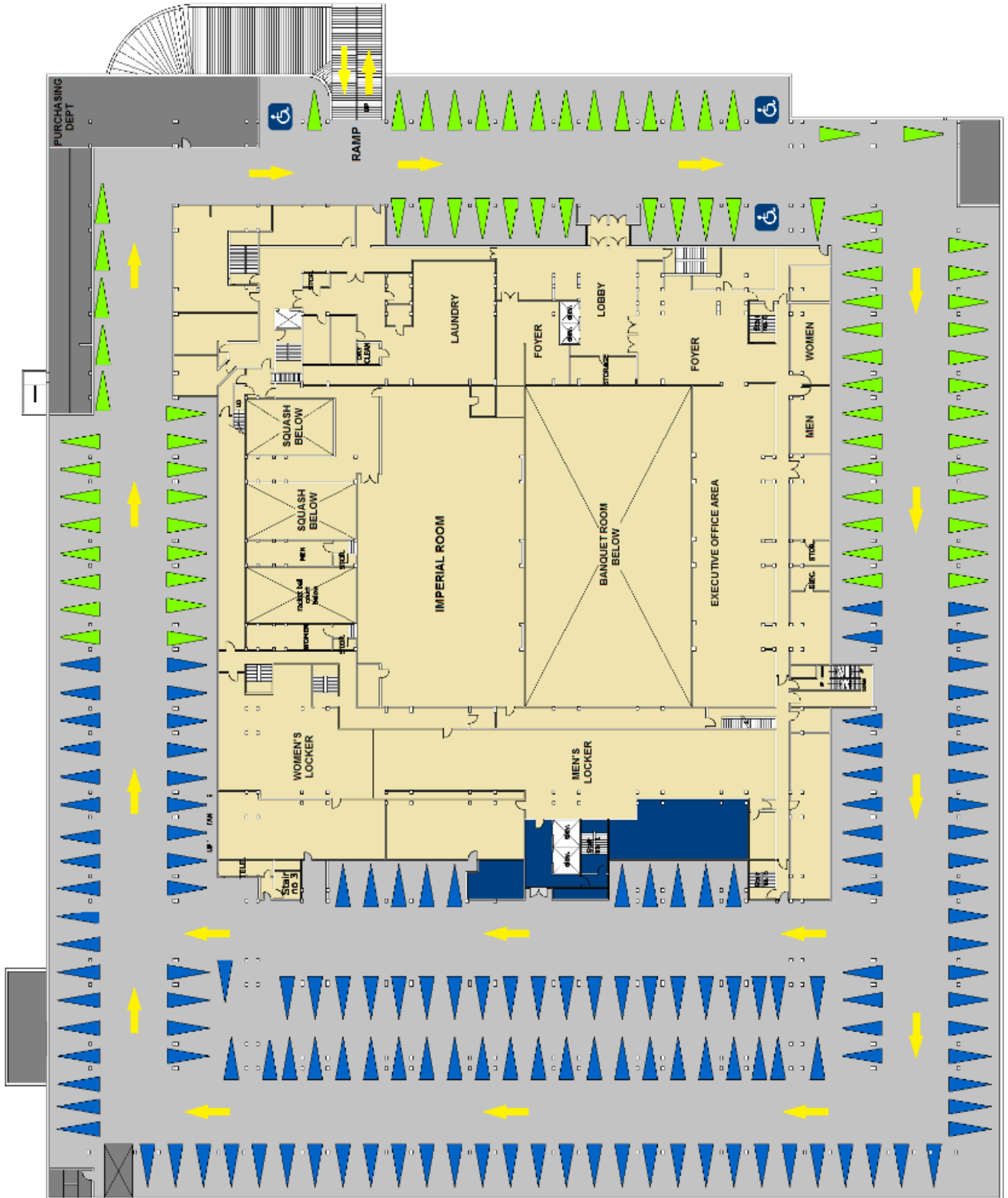

P2 Parking

